

# AM012 AMAZON

<http://www.tiptiptap.ee/en/products/series-amazon-zodiac-nature-world/amazon/amazon-am012>

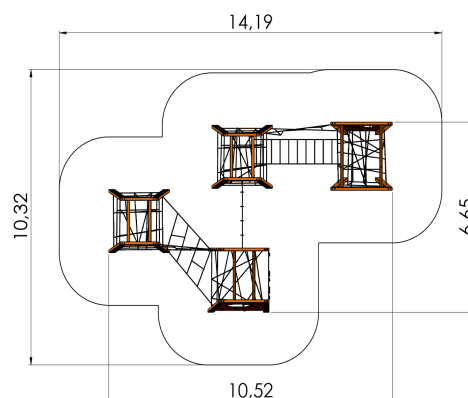
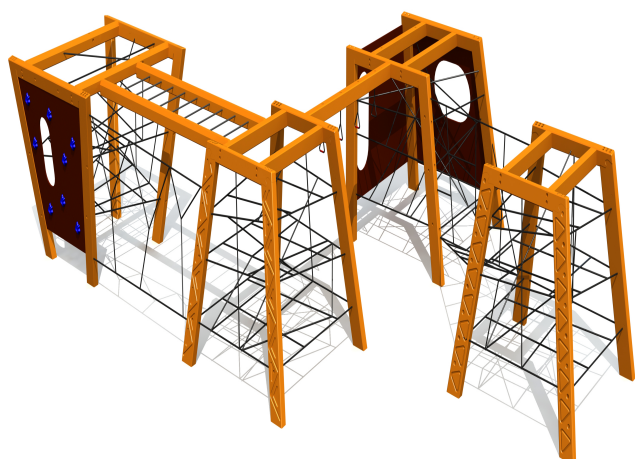

## **Technical information:**

Width of structure: 6.65m

Length of structure: 10.52m

Height of structure: 2m

Max. fall height: 2m

Recommended age of users: 4+

For simultaneous use by several children: 7-14

## **Product consists of:**

Safety area width: 14.19m

Safety area length: 10.32m

Safety area: Yes

[View materials](#)

## **Product description:**

The Amazon range is made of durable laminated timber and it has been awarded the relevant quality certificates. Posts of laminated timber decorated with different ornaments are joined together using the innovative mortise joint. The cross-section of the posts is 100mm x 236mm and the nets between them are made of extremely durable 16mm steel rope designed for climbing which is coated with polyester and features plastic joints. The climbing wall with climbing rocks is made of waterproof birch plywood. The products are concreted to the ground using metal fittings.

For the purpose of safety, it is recommended to use sand or rubber mats beneath the playground facilities.